



FARI DA LAVORO A LED “ELLIPSE” **LED WORKLAMPS**

TEST STANDARDS FOR
ELECTRONIC COMPONENTS

EMC: CISPR 25 class 5

2600 lumen





FARI DA LAVORO A LED "ELLIPSE" "ELLIPSE" LED WORKLAMPS

CARATTERISTICHE

LUNGA DURATA

L'utilizzo di LED di ultima generazione garantisce una durata del dispositivo superiore a 30.000 ore di lavoro.

ROBUSTEZZA & RESISTENZA

Grazie all'impiego di materiali pregiati ed alla tecnologia LED questa gamma di fanali è indicata per usi in condizioni particolarmente gravose.

AFFIDABILITÀ

L'impiego di particolari accorgimenti tecnici, ed un grado di tenuta elevato del sistema elettronico, garantiscono un'elevata resistenza alle vibrazioni ed all'ingresso dell'acqua.

ASSENZA DI MANUTENZIONE

L'adozione di soluzioni tecniche innovative e della tecnologia LED permette di non dover fare alcuna manutenzione ed inoltre non serve effettuare il cambio lampade.

RISPARMIO ENERGETICO

La componentistica elettrica è ottimizzata al fine di ottenere il minor assorbimento possibile.

FEATURES

LONG LIFESPAN

The use of state-of-the-art technology LEDs guarantees a long lifespan of the device, higher than 30.000 hours.

SOLIDITY & RESISTANCE

The use of high-quality materials and LED technology makes this range of lamps specially suitable for heavy-duty applications.

RELIABILITY

Technical solutions, and a full sealing of the lamp's electronical system, have been studied in order to guarantee a high vibration resistance and sealing level.

NO MAINTENANCE

Thanks to the introduction of innovative technical solutions and LED technology, there is no need of maintenance or bulb replacement.

ENERGY SAVING

The electrical system is optimized in order to have the lower possible current consumption.

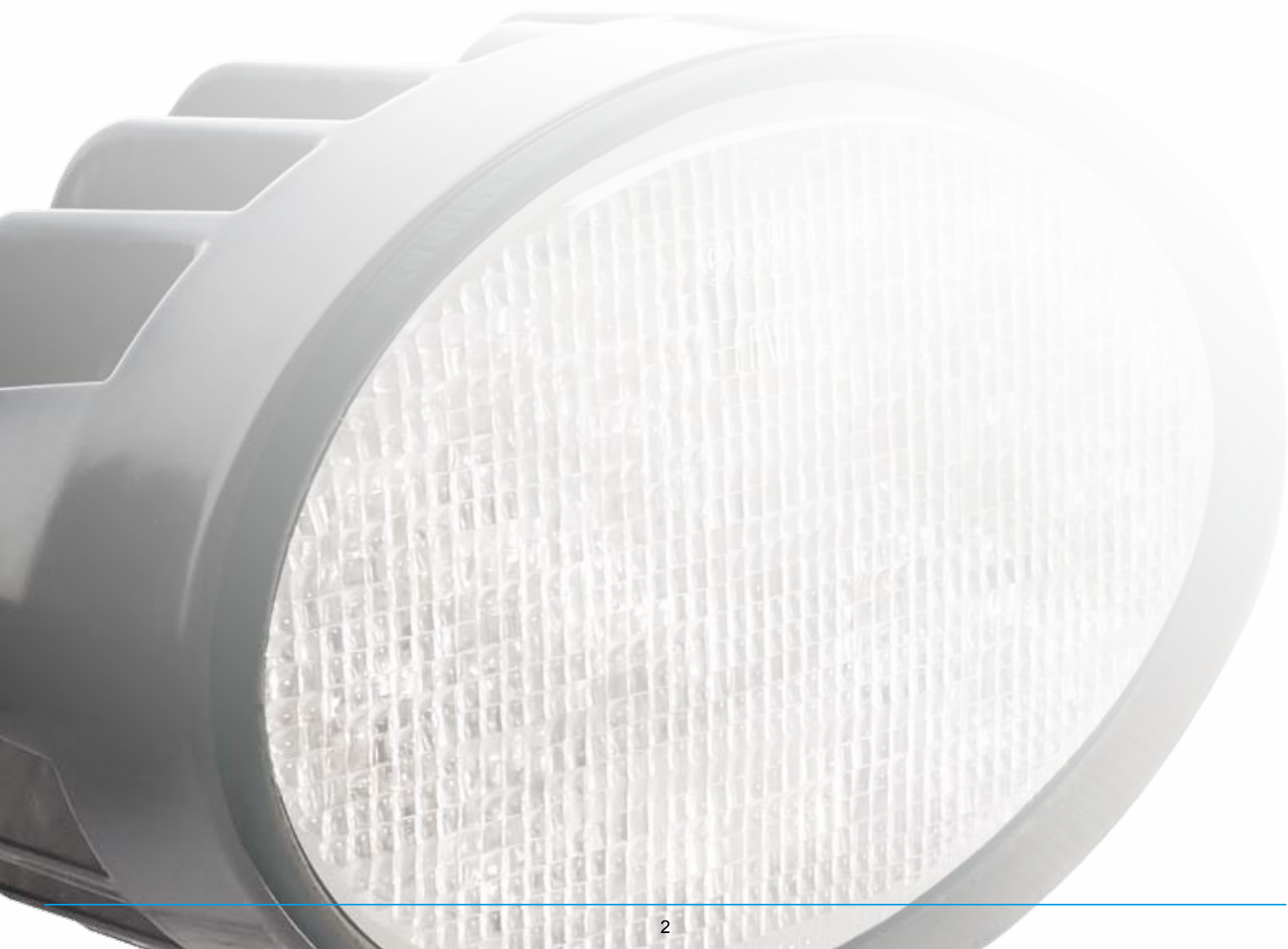



SPECIFICHE TECNICHE TECHNICAL SPECIFICATIONS

SPECIFICHE TECNICHE

Materiale corpo: alluminio
Materiale lente: policarbonato
Tensione di alimentazione: 9 - 32V
Assorbimento di corrente: 2,8A @ 12V / 1,4A @ 24V
Tipo di illuminazione: n°14 LED
Lumen nominali: 3600
Lumen effettivi: 2600
Grado di protezione: IP66 + IP9K
Inversione di polarità: protetto
Load dump: protetto
Temperatura colore: 6000 K
Temperatura di funzionamento:
- 40° C ÷ + 50° C (100% rendimento luminoso)
+ 50° C ÷ + 85° C (riduzione del rendimento luminoso per protezione al surriscaldamento)
Peso: 940 g
Compatibilità elettromagnetica (EMC): 2004/104/CE - ECE R10 - CISPR 25 classe 5
Connessioni: Deutsch 2 vie con cavo - S/Seal 2 vie - Deutsch 2 vie - H9 2 vie



TECHNICAL SPECIFICATIONS

Housing material: aluminium
Lens material: polycarbonate
Power supply voltage: 9 - 32V
Current consumption: 2,8A @ 12V / 1,4A @ 24V
Type of lighting: n°14 LEDs
Raw lumen output: 3600
Effective lumen output: 2600
Sealing: IP66 + IP9K
Reverse polarity: protected
Load dump: protected
Color temperature: 6000 K
Operating temperature:
- 40° C ÷ + 50° C (100% light output)
+ 50° C ÷ + 85° C (light output may be reduced - Overheat protection)
Weight: 940 g
Electromagnetic compatibility (EMC): 2004/104/CE - ECE R10 - CISPR 25 class 5
Connections: Deutsch 2 pins with cable - 2 pins S/Seal - 2 pins Deutsch - 2 pins H9

DIMENSIONI - DIMENSIONS

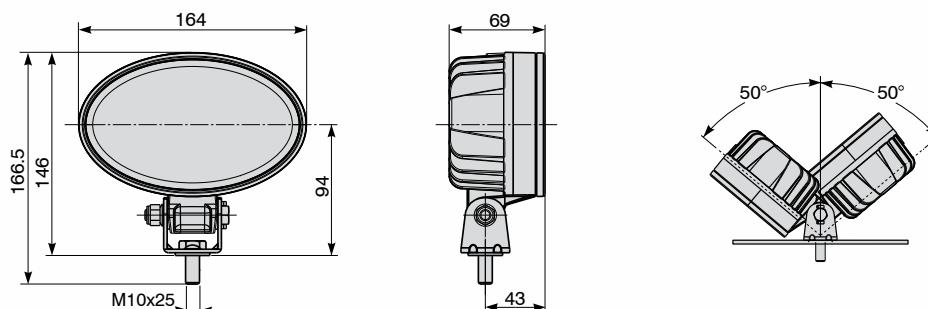

TIPI DI CONNESSIONI - CONNECTION TYPES

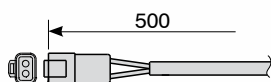

DEUTSCH 2 vie con CAVO
DEUTSCH 2 pins with CABLE

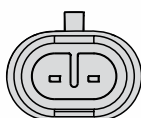

S/SEAL INTEGRATED
2 vie - 2 pins

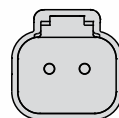

DEUTSCH INTEGRATED
2 vie - 2 pins

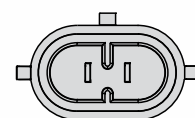

H9 INTEGRATED
2 vie - 2 pins

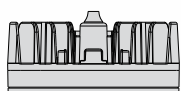
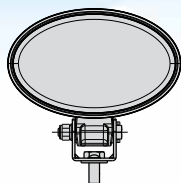
STANDARD

LIGHT PATTERNS	TIPI DI CONNESSIONI - CONNECTION TYPES			
	DEUTSCH con CAVO DEUTSCH with CABLE 2 vie - 2 pins	S/SEAL INTEGRATED 2 vie - 2 pins	DEUTSCH INTEGRATED 2 vie - 2 pins	H9 INTEGRATED 2 vie - 2 pins
HIGH MOUNT FLOOD	05.1711.0000	05.1712.0000	05.1713.0000	05.1900.0000
TRAPEZOIDAL	05.1717.0000	05.1718.0000	05.1719.0000	05.1901.0000
FLOOD REGULAR	05.1797.0000	05.1798.0000	05.1799.0000	05.1902.0000
SPOT REGULAR	05.1815.0000	05.1816.0000	05.1817.0000	05.1903.0000

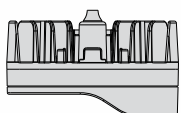
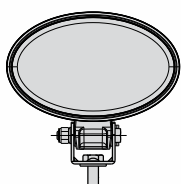
con PALPEBRA RH
with EYELID RH

LIGHT PATTERNS	TIPI DI CONNESSIONI - CONNECTION TYPES			
	DEUTSCH con CAVO DEUTSCH with CABLE 2 vie - 2 pins	S/SEAL INTEGRATED 2 vie - 2 pins	DEUTSCH INTEGRATED 2 vie - 2 pins	H9 INTEGRATED 2 vie - 2 pins
HIGH MOUNT FLOOD	05.1724.0000	05.1725.0000	05.1726.0000	05.1908.0000
TRAPEZOIDAL	05.1730.0000	05.1731.0000	05.1732.0000	05.1909.0000
FLOOD REGULAR	05.1803.0000	05.1804.0000	05.1805.0000	05.1910.0000
SPOT REGULAR	05.1821.0000	05.1822.0000	05.1823.0000	05.1911.0000

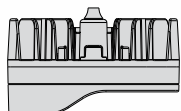
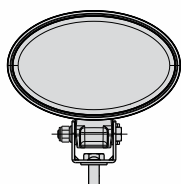
con PALPEBRA LH
with EYELID LH

LIGHT PATTERNS	TIPI DI CONNESSIONI - CONNECTION TYPES			
	DEUTSCH con CAVO DEUTSCH with CABLE 2 vie - 2 pins	S/SEAL INTEGRATED 2 vie - 2 pins	DEUTSCH INTEGRATED 2 vie - 2 pins	H9 INTEGRATED 2 vie - 2 pins
HIGH MOUNT FLOOD	05.1736.0000	05.1737.0000	05.1738.0000	05.1916.0000
TRAPEZOIDAL	05.1742.0000	05.1743.0000	05.1744.0000	05.1917.0000
FLOOD REGULAR	05.1809.0000	05.1810.0000	05.1811.0000	05.1918.0000
SPOT REGULAR	05.1827.0000	05.1828.0000	05.1829.0000	05.1919.0000



VERSIONI VERSIONS

180° STANDARD

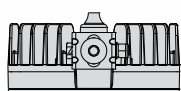
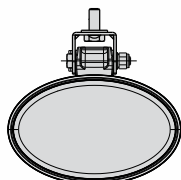

LIGHT PATTERNS	TIPI DI CONNESSIONI - CONNECTION TYPES			
	DEUTSCH con CAVO DEUTSCH with CABLE 2 vie - 2 pins	S/SEAL INTEGRATED 2 vie - 2 pins	DEUTSCH INTEGRATED 2 vie - 2 pins	H9 INTEGRATED 2 vie - 2 pins
HIGH MOUNT FLOOD	05.1714.0000	05.1715.0000	05.1716.0000	05.1904.0000
TRAPEZOIDAL	05.1720.0000	05.1721.0000	05.1722.0000	05.1905.0000
FLOOD REGULAR	05.1800.0000	05.1801.0000	05.1802.0000	05.1906.0000
SPOT REGULAR	05.1818.0000	05.1819.0000	05.1820.0000	05.1907.0000

180° con PALPEBRA RH with EYELID RH

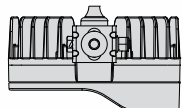
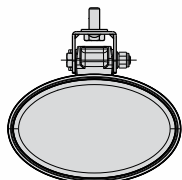

LIGHT PATTERNS	TIPI DI CONNESSIONI - CONNECTION TYPES			
	DEUTSCH con CAVO DEUTSCH with CABLE 2 vie - 2 pins	S/SEAL INTEGRATED 2 vie - 2 pins	DEUTSCH INTEGRATED 2 vie - 2 pins	H9 INTEGRATED 2 vie - 2 pins
HIGH MOUNT FLOOD	05.1727.0000	05.1728.0000	05.1729.0000	05.1912.0000
TRAPEZOIDAL	05.1733.0000	05.1734.0000	05.1735.0000	05.1913.0000
FLOOD REGULAR	05.1806.0000	05.1807.0000	05.1808.0000	05.1914.0000
SPOT REGULAR	05.1824.0000	05.1825.0000	05.1826.0000	05.1915.0000

180° con PALPEBRA LH with EYELID LH

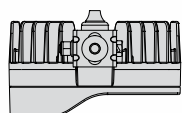
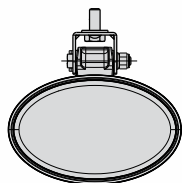

LIGHT PATTERNS	TIPI DI CONNESSIONI - CONNECTION TYPES			
	DEUTSCH con CAVO DEUTSCH with CABLE 2 vie - 2 pins	S/SEAL INTEGRATED 2 vie - 2 pins	DEUTSCH INTEGRATED 2 vie - 2 pins	H9 INTEGRATED 2 vie - 2 pins
HIGH MOUNT FLOOD	05.1739.0000	05.1740.0000	05.1741.0000	05.1920.0000
TRAPEZOIDAL	05.1745.0000	05.1746.0000	05.1747.0000	05.1921.0000
FLOOD REGULAR	05.1812.0000	05.1813.0000	05.1814.0000	05.1922.0000
SPOT REGULAR	05.1830.0000	05.1831.0000	05.1832.0000	05.1923.0000

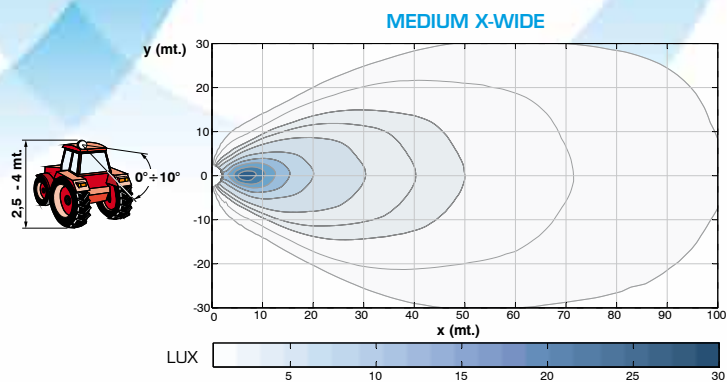

HIGH MOUNT FLOOD

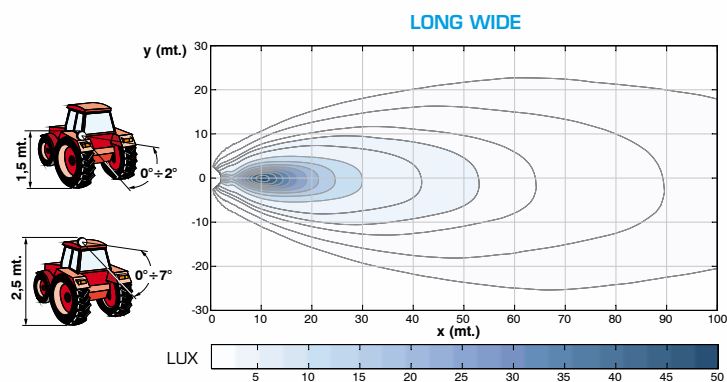

TRAPEZOIDAL

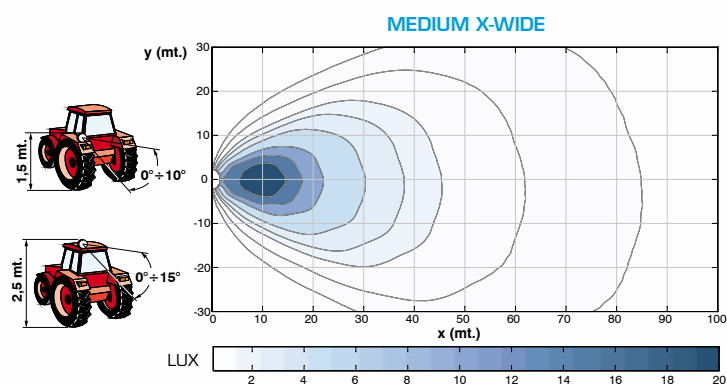

FLOOD REGULAR

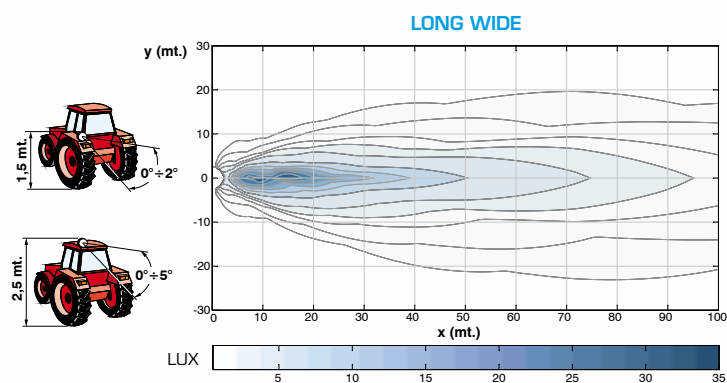

SPOT REGULAR



FARI DA LAVORO A LED "ELLIPSE" "ELLIPSE" LED WORKLAMPS

OPTIONAL KIT

CONNETTORI CONTROPARTE
MATING CONNECTORS

S/SEAL 2 VIE
2 PINS S/SEAL

27.0958.0000



DEUTSCH 2 VIE
2 PINS DEUTSCH

27.0909.0000



LAMPADA H9 2 VIE
2 PINS H9 BULB

27.0915.0000



NOTE NOTES



Headquarters:

Via Tito Speri, 10

25024 Leno (Brescia) ITALY

Phone +39 030 90451

Fax +39 030 9045330

info@cobospa.it

www.cobospa.it