

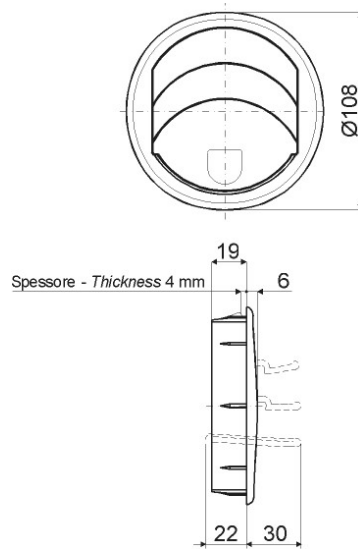









P.316

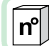

Caratteristiche - Features

-  Secondo codice - According to item code
-  Diffusore aria orientabile a tre alette - Three fins adjustable air diffuser
-  Nero - Black
-  50 pezzi - pieces
-  24,3 dm³
-  3.450 g
-  Sezione tecnica - Technical section pag. 33 - 52

Versioni disponibili / Available versions

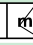
P.316					
	Cod.	Materiale - Material			
	67088	ABS termoresistente - Thermoresistent ABS	•		
	65061	PA + fibra di vetro - PA + glass fibre		•	500

P.316

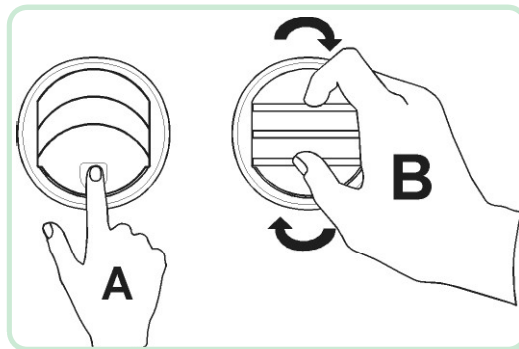
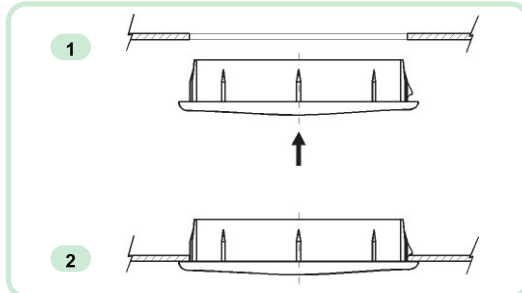
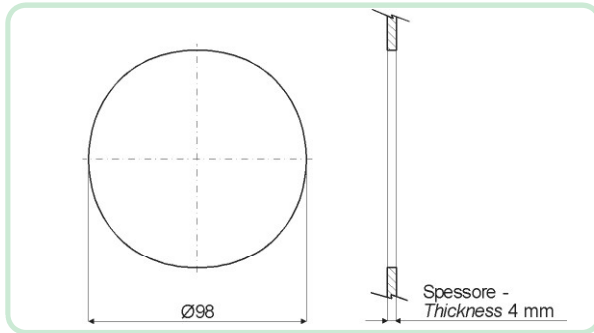

Dima di foratura
Drilling template



Fissaggio - Fixing:
a scatto nella dima predisposta per
l'inserimento -
On release into the presetted template



A Parzializzazione e chiusura flusso aria -
Air flow choking and closing
B Orientamento flusso aria -
Air flow adjustment

Caratteristiche - Features



Sezione utile passaggio aria -
Open air flow section: 4.500 mm²



Temperatura di esercizio -
Working temperature: PA: -10 / 120°C
ABS: 0 / 70°C



Comportamento alla fiamma: conforme dir. 95/28/EC -
Behaviour under flame: agree to 95/28/EC directive

P.410

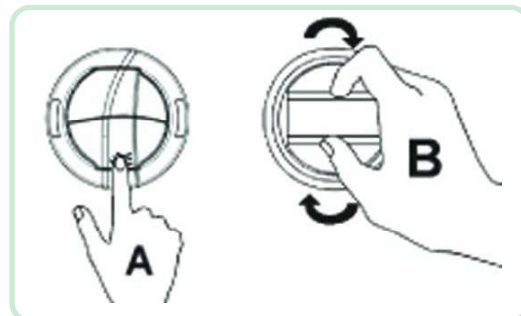
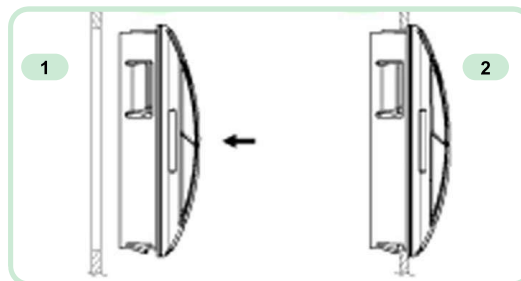
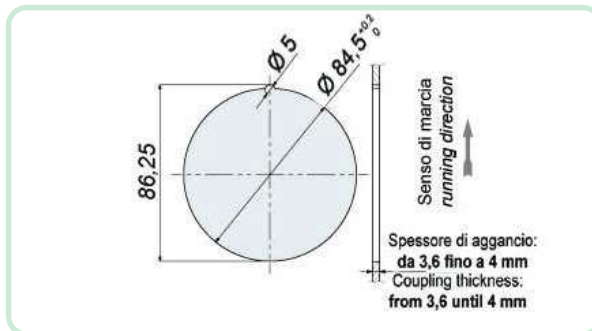

Dima di foratura
Drilling template



Fissaggio - Fixing:
a scatto nella dima predisposta per
l'inserimento -
On release into the presetted template



A Parzializzazione e chiusura flusso aria -
Air flow choking and closing
B Orientamento flusso aria -
Air flow adjustment

Caratteristiche - Features



Sezione utile passaggio aria -
Open air flow section: 2.800 mm²



Temperatura di esercizio -
Working temperature: -10 / 120°C



Comportamento alla fiamma: conforme dir. 95/28/EC -
Behaviour under flame: agree to 95/28/EC directive