







# P.123

## Caratteristiche - Features

-  ABS
-  Diffusore aria - Air diffuser
-  Secondo codice - According to item code
-  50 pezzi - pieces
-  7 dm³
-  1.350 g
-  Sezione tecnica - Technical section pag. 33 - 56



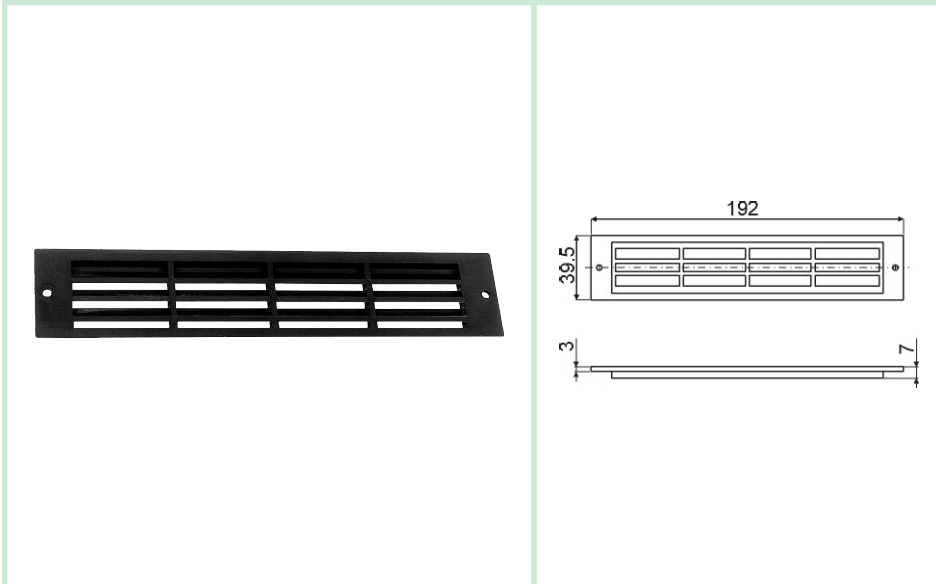







### Versioni disponibili / Available versions

P.123	Cod.	Colore - Colour			
	68900	nero - black	•		
	65582	grigio - grey Ral 7012	•		
	64562	grigio - grey Ral 7001		•	

# P.194

## Caratteristiche - Features

-  ABS
-  Diffusore aria - Air diffuser
-  Secondo codice - According to item code
-  100 pezzi - pieces
-  24,3 dm³
-  3.350 g
-  7 pag. 32
-  Sezione tecnica - Technical section pag. 33 - 56

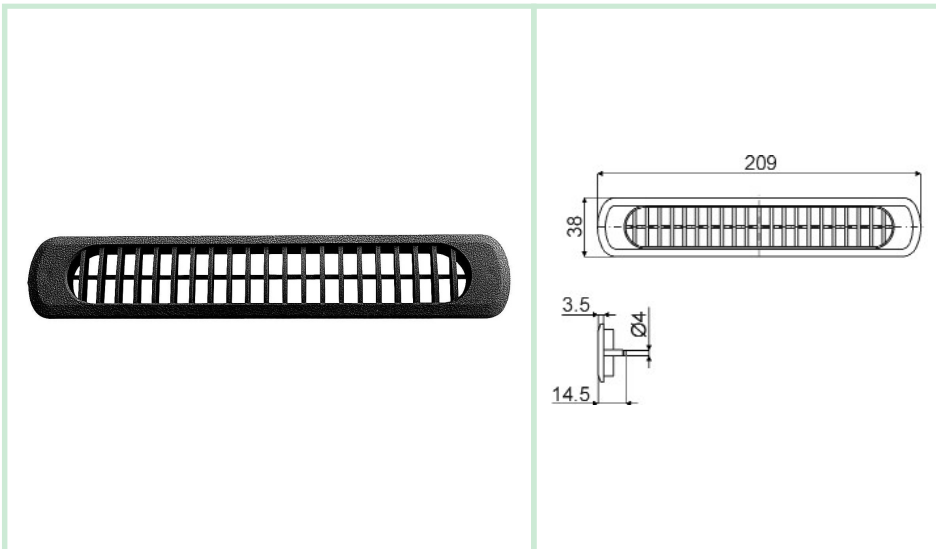

### Versioni disponibili / Available versions

P.194	Cod.	Colore - Colour			
	65767	nero - black	•		
	67319	grigio - grey Ral 7012	•		
	60172	grigio - grey Ral 7044		•	500
	65911	avorio - ivory Ral 8010		•	1000

P.123

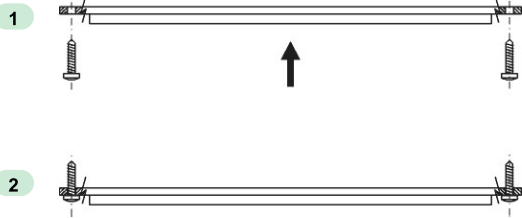
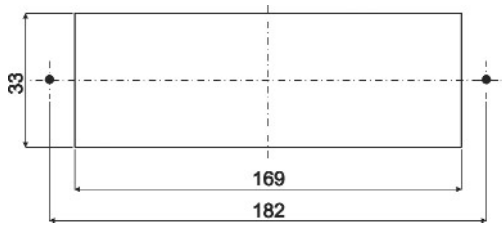

Dima di foratura  
*Drilling template*



Fissaggio - *Fixing:*  
a scatto nella dima predisposta per  
l'inserimento -  
*On release into the presetted template*

**Caratteristiche - Features**



Sezione utile passaggio aria -  
*Open air flow section: 1.400 mm<sup>2</sup>*



Temperatura di esercizio -  
*Working temperature: 0 / 70°C*



Comportamento alla fiamma: conforme dir. 95/28/EC -  
*Behaviour under flame: agree to 95/28/EC directive*

P.194

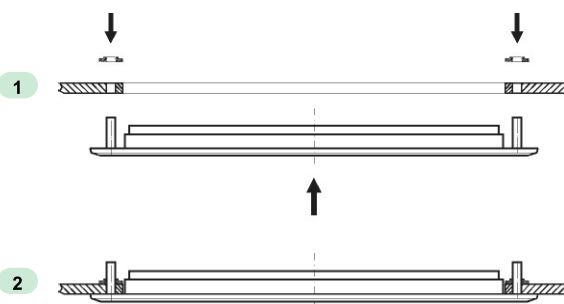

Dima di foratura  
*Drilling template*



Fissaggio - *Fixing:*  
nella dima predisposta + prestele di  
fissaggio - *Into the presetted template +  
fixing plates*



Cod.62388 pag. 32

**Caratteristiche - Features**



Sezione utile passaggio aria -  
*Open air flow section: 2.700 mm<sup>2</sup>*



Temperatura di esercizio -  
*Working temperature: 0 / 70°C*



Comportamento alla fiamma: conforme dir. 95/28/EC -  
*Behaviour under flame: agree to 95/28/EC directive*

P.81

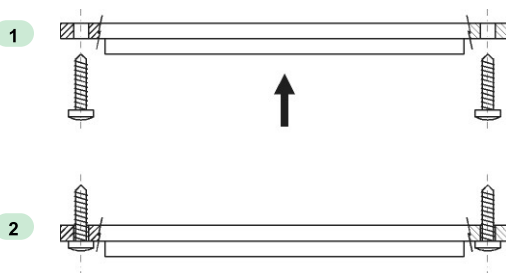
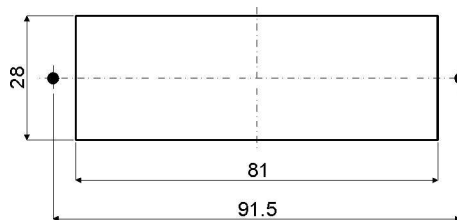
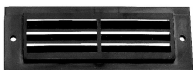

Dima di foratura  
*Drilling template*



Fissaggio - *Fixing:*  
viti autofilettanti  $\varnothing 5$  mm a testa piana (non  
comprese nella confezione); fori di fissaggio da dimensionarsi a seconda del materiale del supporto -

*$\varnothing 5$  mm button head autothreading screws  
(not included in the package) + fixing bushes;  
fixing holes to be dimensioned according to the material of the support*

**Caratteristiche - Features**



Sezione utile passaggio aria -  
*Open air flow section: 1.000 mm<sup>2</sup>*



Temperatura di esercizio -  
*Working temperature: PA -10 / 120°C  
ABS 0 / 70°C*



Comportamento alla fiamma: conforme dir. 95/28/EC -  
*Behaviour under flame: agree to 95/28/EC directive*