

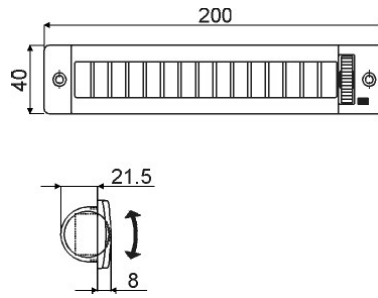

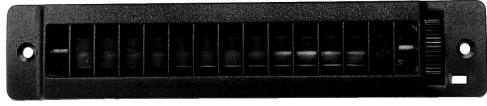







P.110



Caratteristiche - Features

-  Poliammide fibra vetro - Glass fibre polyamide
-  Diffusore aria orientabile - Adjustable air diffuser
-  Secondo codice - According to item code
-  100 pezzi - pieces
-  35,2 dm³
-  5.400 g
-  Sezione tecnica - Technical section pag. 33 - 40





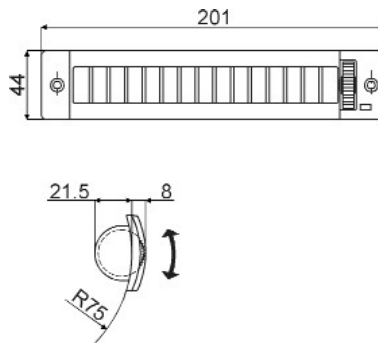
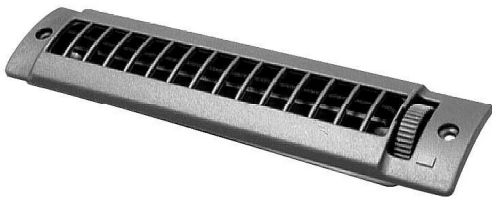

Versioni disponibili / Available versions

P.110	Cod.	Colore - Colour			
	64750	nero - black	•		
	67498	grigio - grey Ral 7012		•	1000

P.110bis



Caratteristiche - Features

-  Poliammide fibra vetro - Glass fibre polyamide
-  Diffusore aria orientabile - Adjustable air diffuser
-  Secondo codice - According to item code
-  100 pezzi - pieces
-  35,2 dm³
-  5.400 g
-  Sezione tecnica - Technical section pag. 33 - 40

Versioni disponibili / Available versions

P.110bis	Cod.	Colore - Colour			
	60138	nero - black	•		500
	67987	grigio - grey Ral 7012		•	500
	65411	grigio - grey Ral 7001		•	1000

P.252

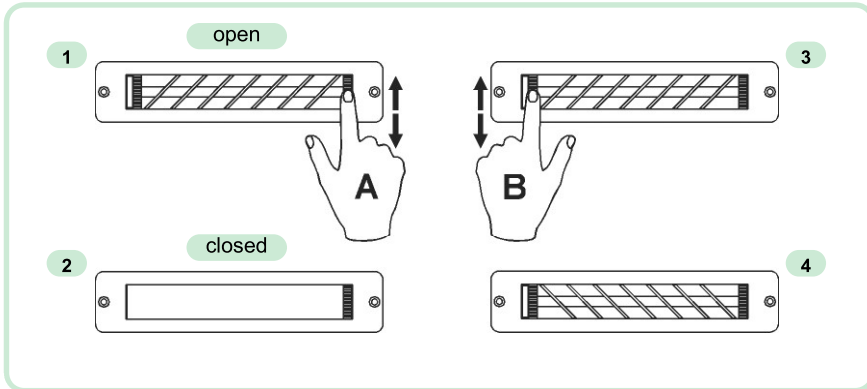
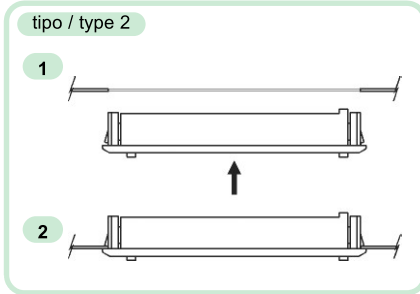
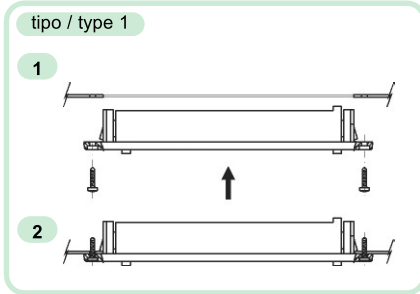
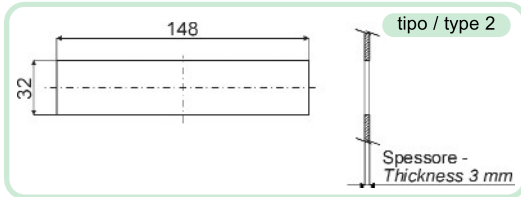
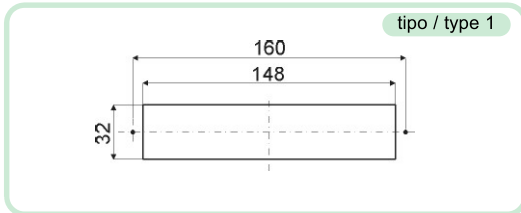

Dima di foratura
Drilling template



Fissaggio - Fixing:
tipo/type 1: viti autofilettanti $\varnothing 3$ mm a testa piana (non comprese nella confezione), fori di fissaggio da dimensionarsi a seconda del materiale del supporto - $\varnothing 3$ mm button head autothreading screws (not included in the package), fixing holes to be dimensioned according to the material of the support

tipo/type 2: a scatto nella dima predisposta per l'inserimento - On release into the presetted template



A Parzializzazione e chiusura flusso aria - Air flow choking and closing
B Orientamento flusso aria - Air flow adjustment

Caratteristiche - Features



Sezione utile passaggio aria - Open air flow section: 1.450 mm²



Temperatura di esercizio - Working temperature: -10 / 120°C



Comportamento alla fiamma: conforme dir. 95/28/EC - Behaviour under flame: agree to 95/28/EC directive

P.110-110bis

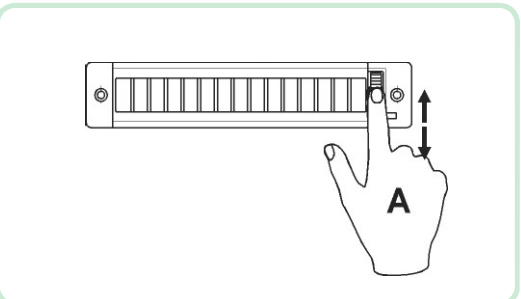
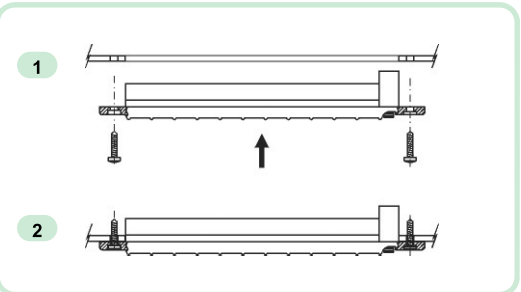
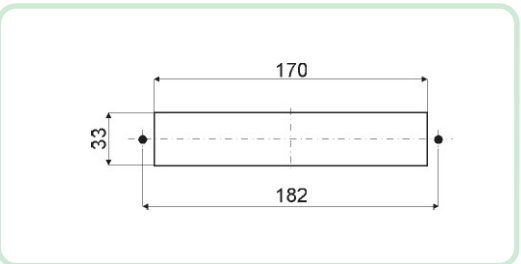

Dima di foratura
Drilling template



Fissaggio - Fixing:
viti autofilettanti $\varnothing 4$ mm a testa piana (non comprese nella confezione), fori di fissaggio da dimensionarsi a seconda del materiale del supporto -

$\varnothing 4$ mm button head autothreading screws (not included in the package), fixing holes to be dimensioned according to the material of the support



A Parzializzazione, chiusura e orientamento flusso aria - Air flow choking, closing and adjustment

Caratteristiche - Features



Sezione utile passaggio aria - Open air flow section: 1.800 mm²



Temperatura di esercizio - Working temperature: -10 / 120°C



Comportamento alla fiamma: conforme dir. 95/28/EC - Behaviour under flame: agree to 95/28/EC directive